



**WELCOME TO MICRO PLAST**

# OUR JOURNEY



- **Micro Tech was established in the year 2007 by Mr. P Ravikumar to start with Tool Room to manufacture high precision injection moulds.**
- **Micro Plast was established in the year 2014 by Mr. P Ravikumar & Mr. V Subba Rao to manufacture plastic injection moulding components.**
- **Plastic Injection Moulding Production started in 2014 to manufacture plastic injection moulded components.**

## **MICRO PLAST CORE TEAM**

- **Mr. P Ravikumar, Managing Partner - Tool Room Section**
- **Mr. V Subba Rao , Managing Partner – Plastic Injection Moulding Section**

# MICRO PLAST'S ORG. STRUCTURE

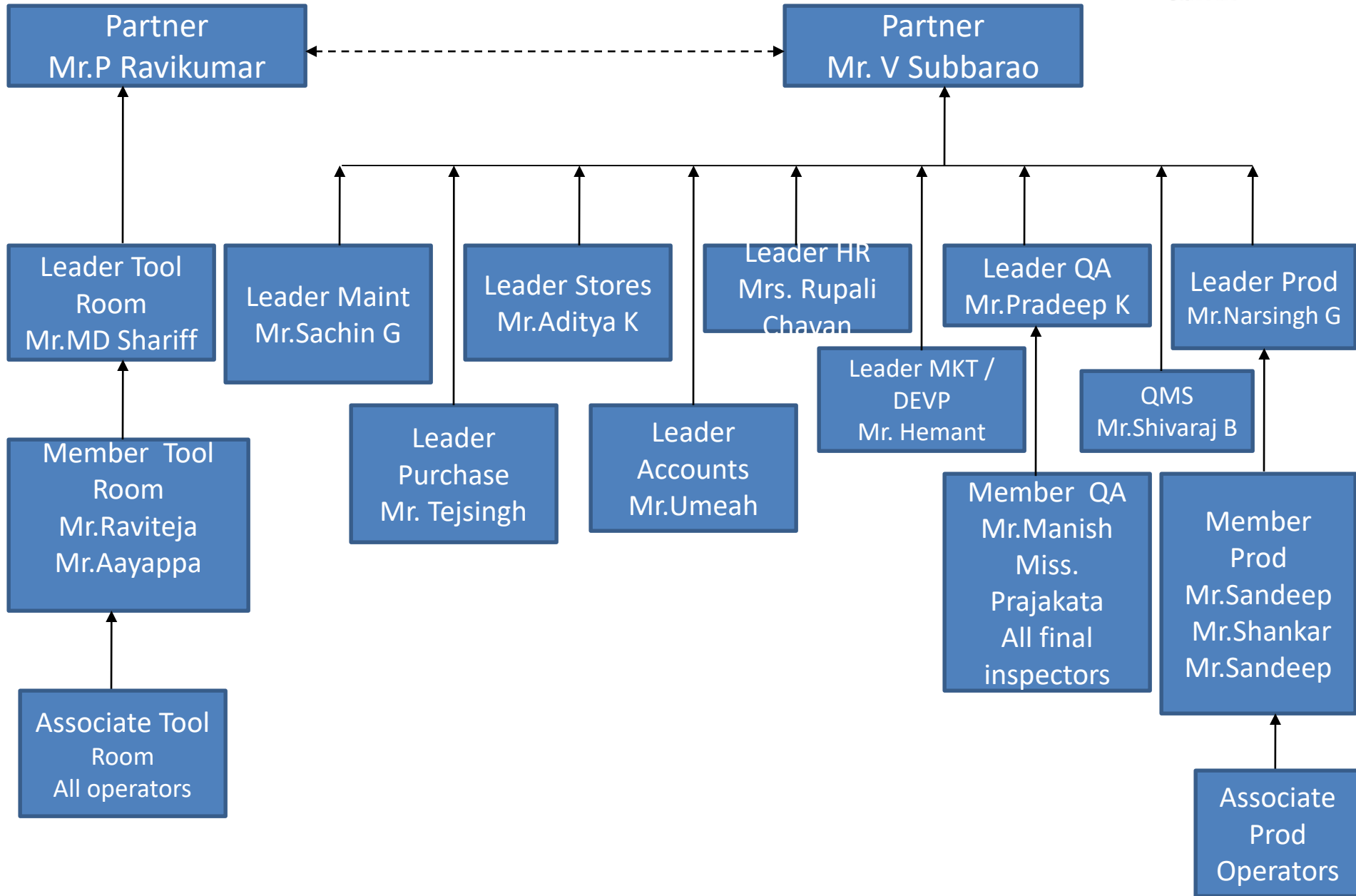

# TOTAL AREA / LOCATION



- Total area is 64,000 Sq. Ft, Plastic Injection Moulding area is 56000 Sq. Ft.
- Tool Room Section Area is 8000 Sq. Ft.
- No. of plants : 04
- Location1: Plot No. 159, Sector 7, PCNDTA, Bhosari, Pune - 411026
- Location2:1555/1556 Shelar wasti Near iifa weight bridge Talawade.

## Location – Bhosari , Pune, Maharashtra

- Manufacturing unit is located at Bhosari, in the vicinity of Pune, which is a hub for the automobile & auto components industry
- Major industrial and engineering hub with high presence of outsourced manufacturing companies
- Easy availability of skilled manpower (More than one lakh engineers are working in and around Pune, a number unmatched anywhere in the world)

## Bhosari , Pune distance from key locations

- Bhosari is about 15 kilometers from Pune, About 150 kilometers from Mumbai and 175 kilometers from Nashik
- It is also on the roads that connect the Pune-Mumbai Highway to the Pune-Nashik Highway and to the Pune-Ahmednagar-Aurangabad Highway
- JNPT to Bhosari – 125 Km
- Anand, Gujarat – Bhosari 586 Km
- Purandar village, located 30 km from Bhosari has been identified as a probable site for the proposed Pune International Airport

# GROWTH - TURNOVER

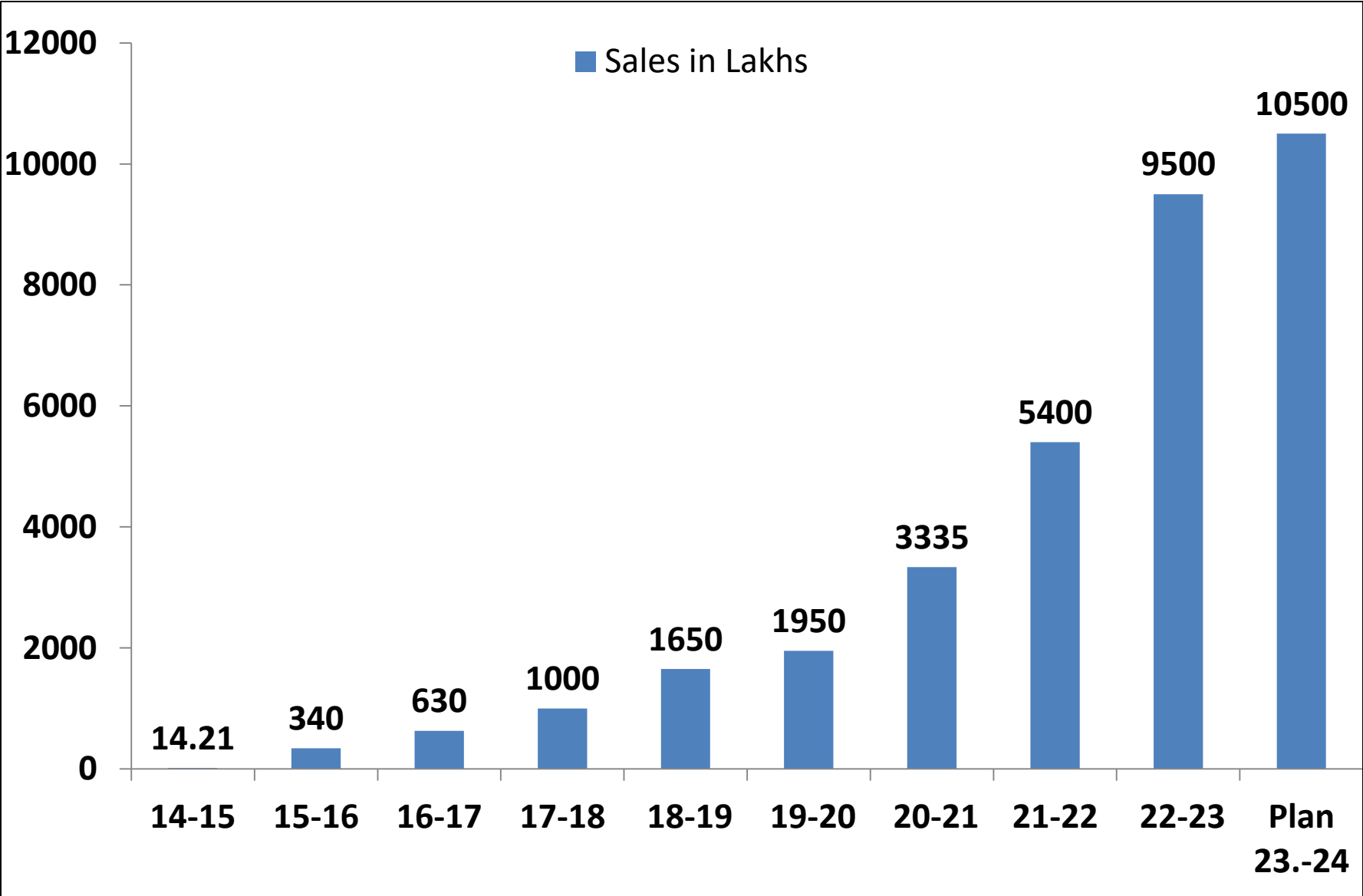

# OUR EMPLOYEE STRENGTH



**TOTAL – 380**

DEPT.	NO. OF EMPLOYEES
TOOL ROOM	25
QUALITY MANAGEMENT SYSTEM	2
QUALITY ASSURANCE	15
SALES & BUSINESS DEVELOPMENT	6
PRODUCTION	100
PURCHASE	2
FINAL INSPECTION	204
STORES	19
MAINTENANCE	4
HR	2
A/C & FINANCE	1





# CERTIFICATIONS

# CERTIFICATIONS



- IATF 16949:2016QMS

Bureau Veritas Certification



**Certificate of Approval**  
Awarded to  
**MICROPLAST**

**PLOT NO.159, SECTOR NO.7, PCNTDA, BHOSARI  
PUNE - 411026, MAHARASHTRA, INDIA**

Extended site(s) : Page 2 to 2

Bureau Veritas Certification certify that the Quality Management System of the above organisation has been audited and found to be in accordance with the requirements of

**IATF 16949 - First Edition**  
and the applicable customer specific requirements



**SCOPE**

Manufacturing

**PERMITTED EXCLUSION(S)**

8.3 - Design and development of products and services

**PRODUCT(S) DELIVERED**

PLASTIC INJECTION MOULDED COMPONENTS AND SUBASSEMBLIES

Date Of Certification: 31 January 2022  
Date Of Expiration: 30 January 2025  
IATF Certificate N°: 442624  
Bureau Veritas Certification Certificate N°: IN039815- IATF Revision: 1

For Bureau Veritas Certification Holding, Le Triangle de l'Arche, 8 Cours du Triangle - 92800 Puteaux - France  
(The official document is in English. Any translations of this document shall be used for reference only.)





# CERTIFICATIONS



- **DUNS Registered Certificate**

dun & bradstreet

D-U-N-S® Registered™ Certificate

The logo for D-U-N-S Registered, featuring a circular emblem with "DUN & BRADSTREET" around the perimeter and a stylized "&" in the center, with "D-U-N-S® REGISTERED™" in a dark blue box below it.

Company Name: MICRO PLAST

Address: Sector No. 7, Plot No. 159, Pcntda, Bhosari, Pune- 411019, Maharashtra, India

Place of Issue: Mumbai

GST Number: 27AAZFM6461AIZY

D-U-N-S Number: 878813762

Validity: From Wednesday, May 31, 2023 to Friday, May 31, 2024

# AWARDS / REWARDS



**Best Supplier Award for NPD from Sigma for the year 16-17**



**Best Supplier Award for Quality from Sigma for the year 16-17**



**Excellent Efforts- New project launch From Taco for year 2017-18**

# AWARDS / REWARDS



**Quality Excellence Award from BHTC for the year 2021-2022**

# AWARDS / REWARDS



**Best supplier Award from Taco for the year 2022**



**Excellent Efforts- New project launch From  
Marquardt India for year 2023-24**

# AWARDS / REWARDS



**Highest Number of Kaizens Award From Sigma for year  
2023-24**

# MANUFACTURING PROCESS FLOW

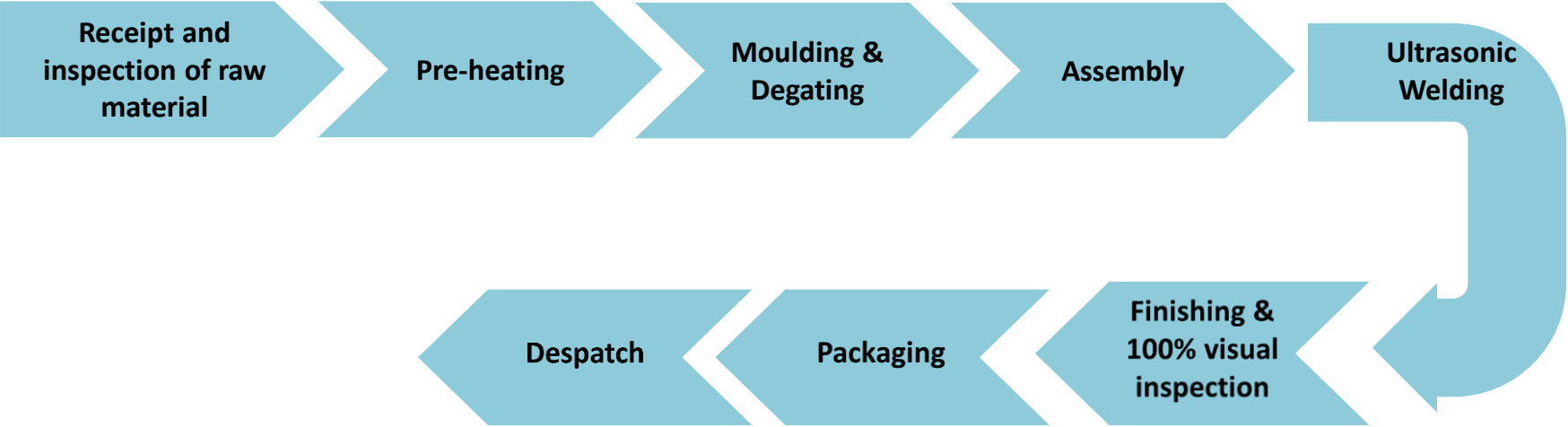



# MANUFACTURING FACILITIES



# PLASTIC INJECTION MOULDING



**WE HAVE TOTAL 40 PLASTIC INJECTION MOULDING MACHINES WITH 100 TO 850 TON'S.**

# PLASTIC INJECTION MOULDING



**WE ARE PROVIDE ROBO SPECIALITY ON  
MACHINES**

# INJECTION MOULDING MACHINE SPECIFICATIONS



Sr. No.	M/C Model	No. Of machines	Distance between Tie bars ( h * v )	Minimum Mould Height	Maximum Mould Height
1	L & T Demag Detech 100T – shot wt. 96 gms	2 no	350* 350	180 mm	400 mm
2	L & T Demag Detech 150T – shot wt. 150 gms.	6 nos.	420* 420	200 mm	460 mm
3	L & T Demag Detech 180T – shot wt. 350 gms	17 nos.	500* 500	200 mm	700 mm
4	L & T Demag Detech 250T – shot wt. 700 gms	10 nos.	580*580	340 mm	700 mm
5	L & T Demag Detech 350T – shot wt. 700 gms	1 no.	640 * 640	330mm	830 mm
6	L & T Demag Detech 450T – shot wt. 746 gms	1 no.	720*720	380mm	850mm
7	L & T Demag Detech 550T – shot wt. 1103 gms	1 no.	810*810	380mm	900mm
8	L & T Demag Detech 650T – shot wt. 1103 gms	1 no.	870*870	380mm	900mm
9	L & T Demag Detech 850T – shot wt. 1103 gms	1 no.	1000*900	450mm	1070mm

# ULTRASONIC WELDING MACHINE



**WE HAVE TWO  
ULTRASONIC  
WELDING  
MACHINE(1500W &  
2500W) FOR  
WELDING OF  
PLASTIC INJECTION  
MOULDING  
COMPONENTS**

# HEAT STACKING MACHINE



# ACCESSORIES



**INJECTION MOULDING FACILITY IS EQUIPPED WITH MODERN ACCESSORIES, LIKE HOOPER DRYER, HOT AIR OVEN, OIL MOULD TEMPERATURE CONTROLLER, ELECTRICAL HOIST, COMPRESSOR, ETC.**

# ACCESSORIES



**INJECTION MOULDING FACILITY IS EQUIPPED WITH MODERN ACCESSORIES, LIKE CHILLER, DEHUMIDIFIED AIR DRYER, ETC.**

# SPECIFICATIONS OF ACCESSORIES



Sr. No.	Model / Particulars	Capacity
1	Hopper dryer For L & T 250T	125 Kgs. – 5 nos.
2	Hopper Dryer For L & T 180T	75 Kgs. – 4 nos.
3	Hopper Dryer For L & T 150T	50 Kgs. – 2 nos.
4	Hopper Dryer For L & T 100T	25 Kgs
5	Hot Air OVEN	50 Kgs. – 2 nos.
6	Oil Mould Temp. Controller	120 deg C – 3 nos.
7	Hot Runner Controller	6 Zone, 4 zone, 2 zone
8	Electrical Hoist	10 Ton
9	Compressor ELGI Make	10.6 cfm





## **PRODUCTS AND SERVICES OFFERED :**

- Design and Manufacturing of Injection Moulds, Prototype moulds.
- We manufacture Injection moulds up to 350 Ton Moulding machine capacity.
- All Tool Room related activities.
- VMC and CNC Sparking services.
- Mould designing in CATIA V5 and Unigraphics NX softwares.
- VMC Programming in Work NC V21.
- Using Work Explore software in Tool Room for viewing, checking, translating the 3D designs.

# TOOL ROOM FACILITIES



PINNACLE VMC



BFW VMC



ZNC EDM



CNC SODICK EDM



EDM



MILLING



GRINDING



WIRE CUT

**FULL FLEDGED INHOUSE TOOL ROOM FACILITY IS AVAILABLE TO MAKE PLASTIC INJECTION MOULDS INCLUDING VMC, CNC EDM, MILLING, SURFACE GRINDING, DRILLING, WIRE CUTTING MACHINE, ETC.**

## High Speed VMC Machine :



## MACHINE DETAILS:

- Machine make : **Makino**
- Machine model : **PS 65**
- Movement : X-Axis:660 mm, Y-Axis:510 mm, Z-Axis:460 mm
- Spindle RPM : 14,000
- Maximum work piece weight : 600 Kg
- ATC : 30 Tools capacity
- Installed Blum for taking references for cutter

## High Speed VMC Machine :

### MACHINE DETAILS:



- Machine make : **Makino**
- Machine model : **F3**
- Movement : X-Axis:650 mm, Y-Axis:500 mm, Z-Axis:450 mm
- Spindle RPM : 12,000
- Maximum work piece weight : 800 Kg
- ATC : 20 Tools capacity
- Installed Blum for taking references for cutter

# TOOL ROOM FACILITIES



## VMC Machines :



Sr.No	Machine details	Specification
1	Pinnacle LV-117	X , Y, Z axis 1140 *710*610
2	Pinnacle LV-96	X , Y, Z axis 1008 *618*611
3	BFW – AGNI +	X , Y, Z axis 601*451*501



## CNC Wire cutting Machine :

### MACHINE DETAILS:

- Machine make : **Makino**
- Machine model : **U3**
- Movement : X-Axis:370 mm, Y-Axis:270 mm, Z-Axis:220 mm
- Maximum work piece size : 770 x 590 x 220 mm
- Maximum work piece weight : 600 Kg
- U Axis & V Axis :  $\pm 50$  mm



## CNC Sparking Machine :



### MACHINE DETAILS:

- Machine make : **Sodick**
- Machine model : **AG 60 L**
- Movement : X : 600 mm, Y : 420 mm, Z : 370 mm
- Work table size : 750 \* 550 mm
- Maximum work piece weight: 1500 Kg
- Maximum weight of electrode : 50 Kg
- Surface roughness values of 'Ra' & 'VDA' grades can be achieved.
- Using Erowa holders for reducing the electrode setting time



## CNC Sparking Machine :



### MACHINE DETAILS:

- Machine make : **Sodick**
- Machine model : **AD 35 L**
- Movement : X : 350 mm, Y : 250 mm, Z : 270 mm
- Work table size : 600 \* 400 mm
- Maximum work piece weight: 550 Kg
- Maximum weight of electrode : 50 Kg
- Surface roughness values of 'Ra' & 'VDA' grades can be achieved.
- Using Erowa holders for reducing the electrode dialing time



# TOOL ROOM FACILITIES



## Sparking Machines :



Sr.No	Machine details	Specification
1	ELECTRONICA ZNC	X , Y, Z axis 200*150*200
2	ELECTRONICA 5030	X , Y, Z axis 250*150*150



# TOOL ROOM FACILITIES



## Conventional Machines :



Sr.No	Machine details	Specification
1	MICROMILL Co – Ordinate Milling Machine with D.R.O	X , Y, Z axis 1300*400*300
2	MANFORD Co – Ordinate Milling Machine with D.R.O	X , Y, Z axis 1200*400*300
3	Surface Grinding - Okamoto	X , Y, Z axis 450*150*300
4	Surface Grinding - JONES-SHIPMAN	X , Y, Z axis 2000*500*250
5	Surface Grinding - JONES-SHIPMAN	X , Y, Z axis 2000*500*250
6	Lathe	4 feet
7	Radial Drilling Machine	Ø 50mm



# MEASURING FACILITIES



## List of Measuring Instruments :



Sr. No.	Machine	Specification
1	Vernier Height Gauge	0 -300 mm
2	Double column Vernier Height Gauge with Dial Indicator	0 -300 mm, 0.01mm L.C.
3	Vernier Caliper	0 -150 mm, 0 - 300mm, L.C.0.01mm
4	Micrometers	Up to 100 mm
5	Depth Micrometer	Up to 100 mm
6	Sine Vice	150 mm
7	Dial Indicators	0.01 mm L.C.
8	Slip Gauges	0.5 - 50 mm
9	Bore Gauge	16 – 40 mm with least count 0.01mm
10	Surface Plate - Jafuji	1000 * 630 * 150 mm



## **VIDEO MEASURING MACHINE WITH RANGE**

**X Coordinate: 0 - 250mm**

**Y Coordinate: 0 - 150mm**

**Z Coordinate: 0 - 200 mm**

# MEASURING FACILITIES RELATION GAUGES

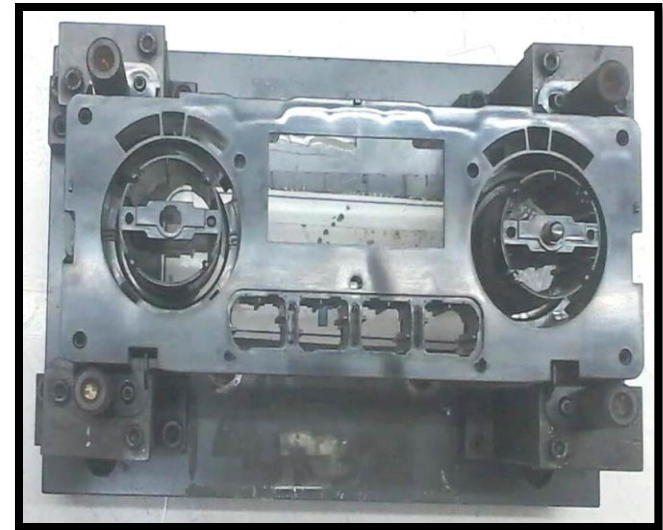
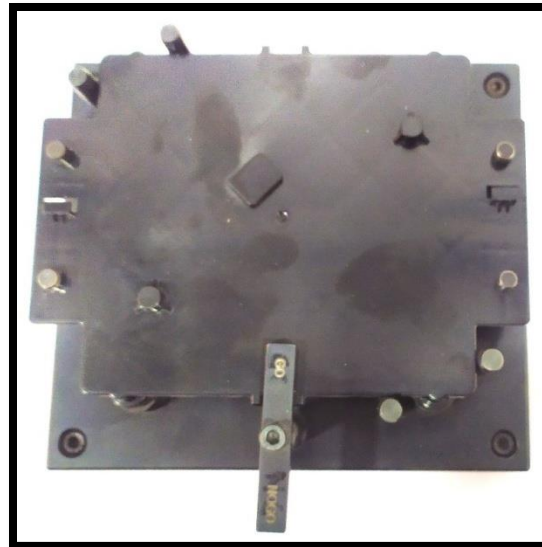
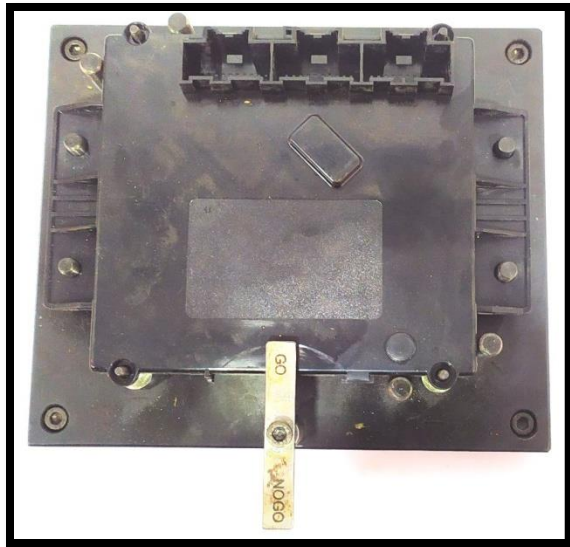
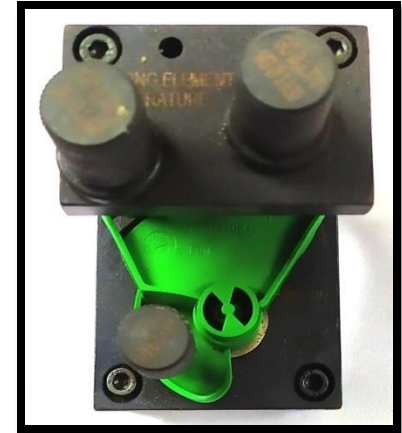
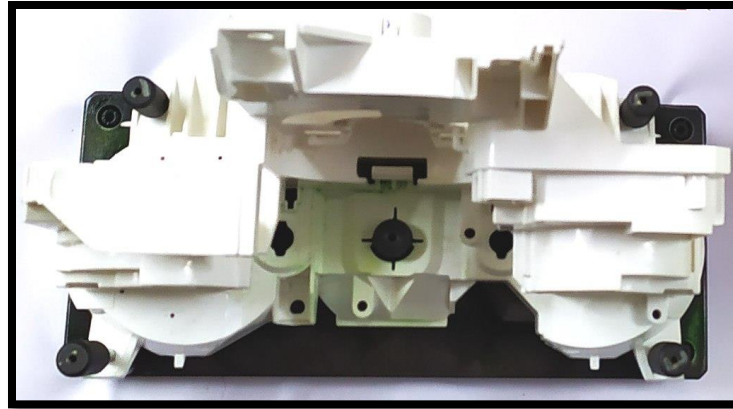
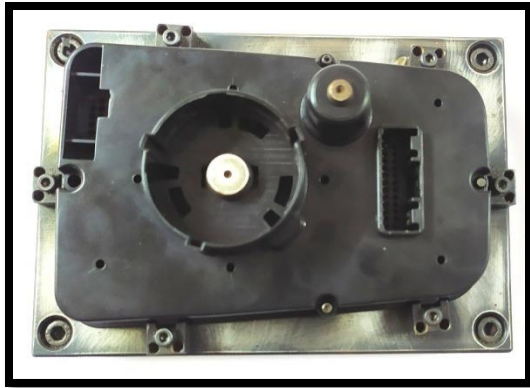

# FEW MOULDS

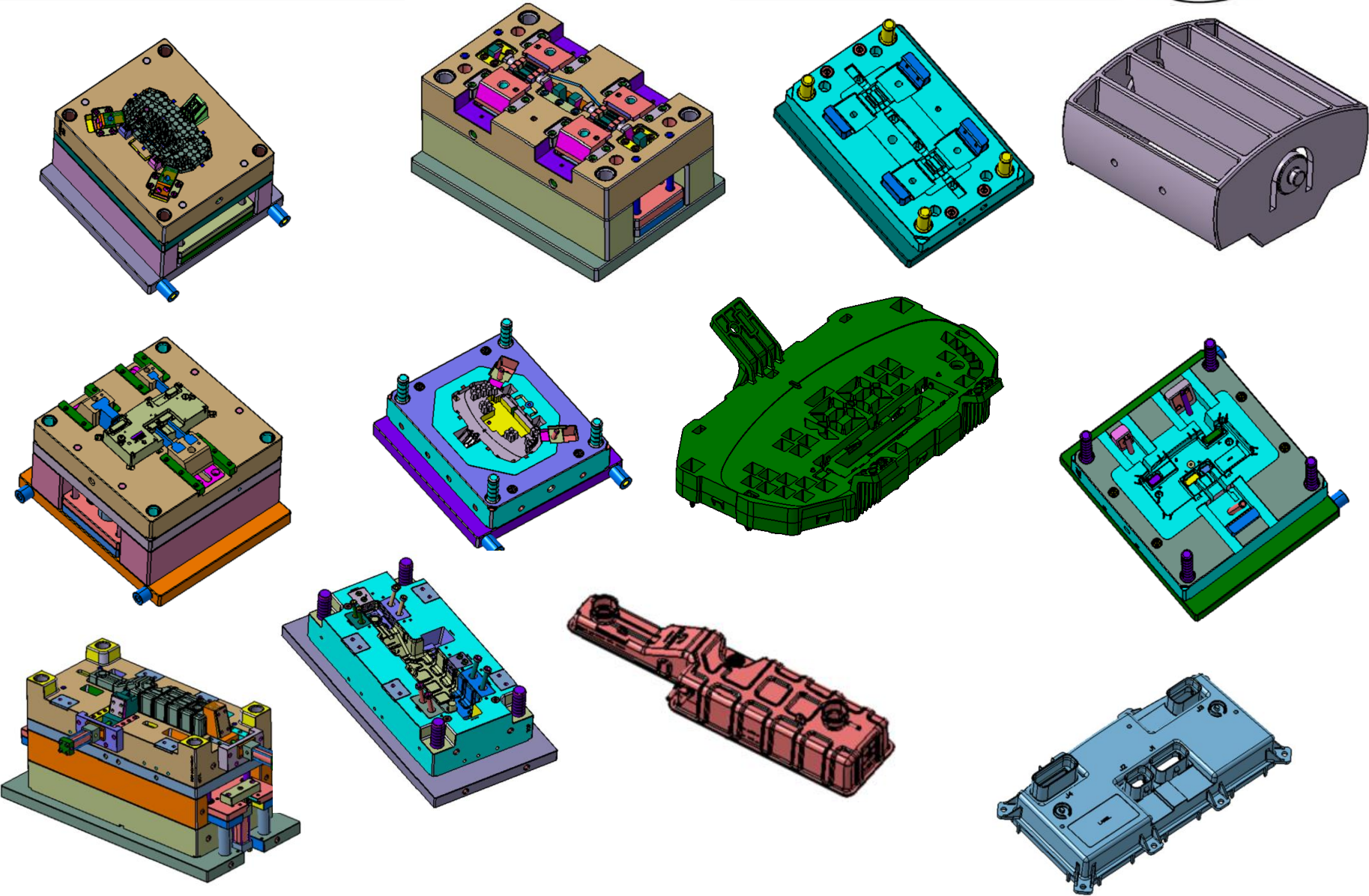

# IMPLEMENTATION OF ERP SYSTEM



**IMPLEMENTATION OF ERP  
SYSTEM IS METICULOUS TO  
BRING IN TRANSPARENCY  
IN OUR OPERATIONS AND  
DATA**



# FEW PRODUCTS

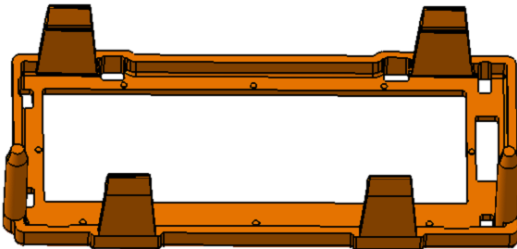
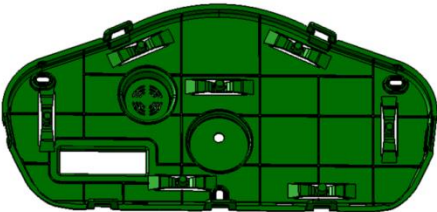
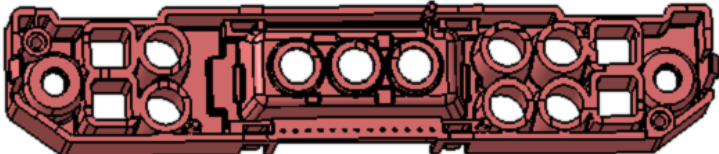
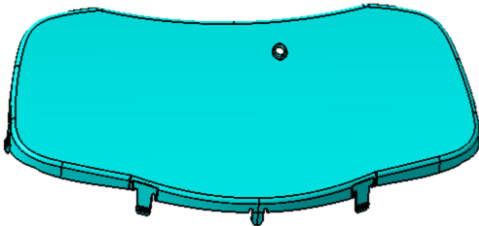



# FEW PRODUCTS

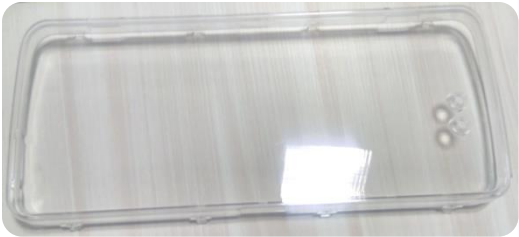

# FEW PRODUCTS

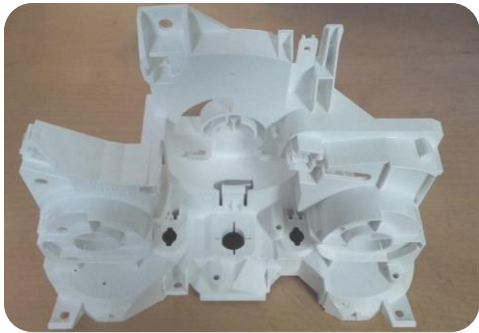
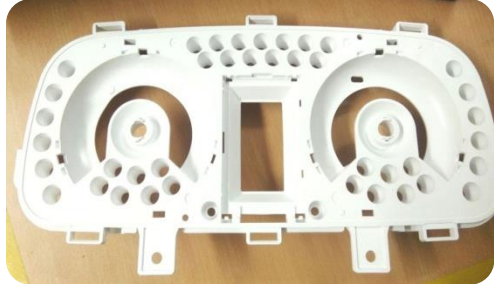

# FEW PRODUCTS

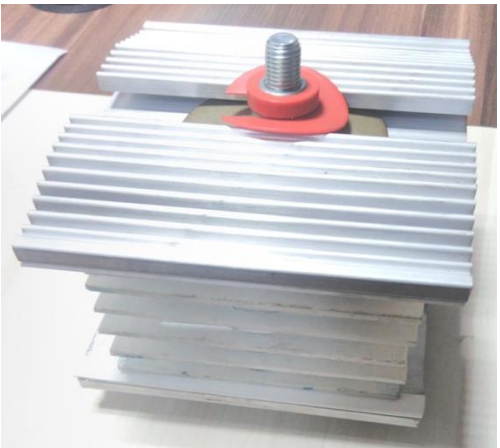
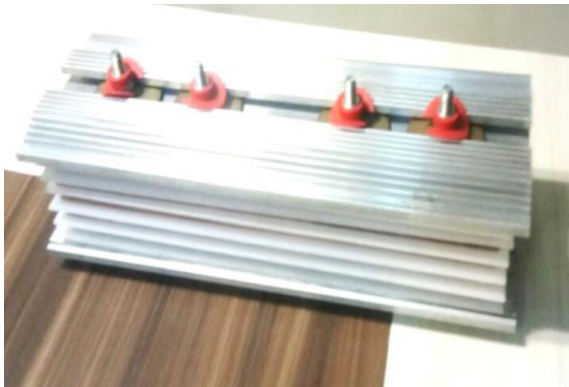
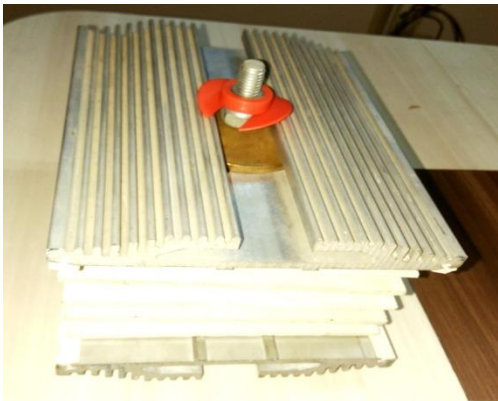
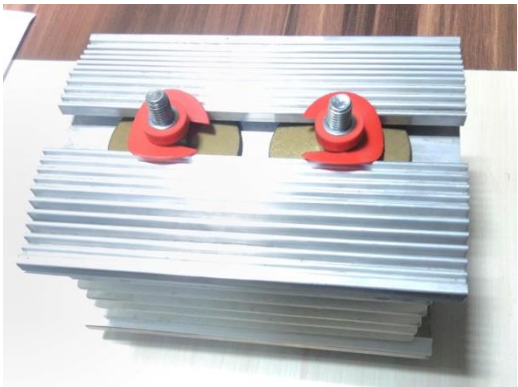

# FEW PRODUCTS

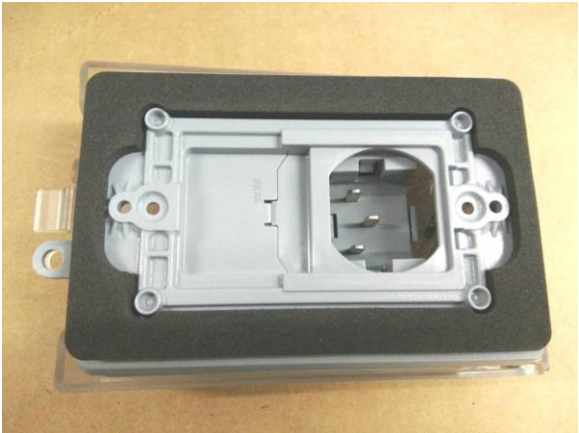
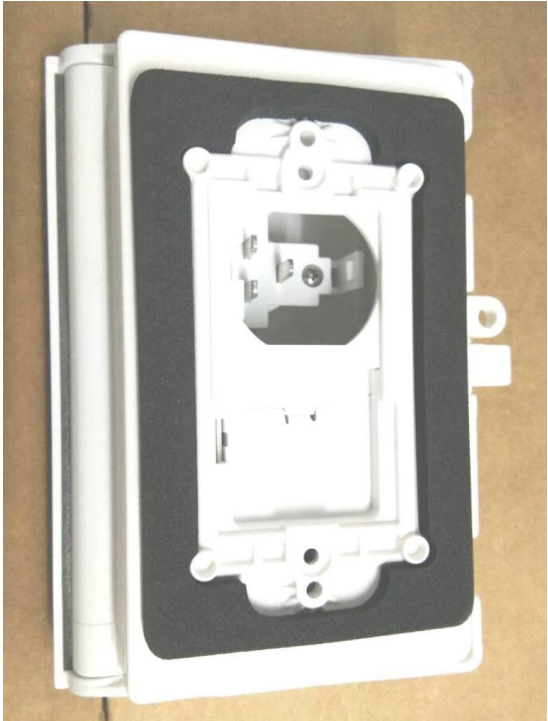

# RAW MATERIAL GRADES



**RAW MATERIAL GRADES ARE STRICTLY USED AS PER CUSTOMER SPECIFIED DRAWINGS LIKE ABS, PP, PC, POM, NYLON 66, PCABS, HDPE & PMMA, ETC.**





**RELIANCE**

**STYROLUTION**

**SABIK**

**COVESTRO (BAYER)**

**POLYPLASTICS**

**ARKIMA**

**DUPONT**

**LANXESS**

**DSM**

**mitsui**

**BASELL**

# MAJOR AUTOMOTIVE CUSTOMERS



# MAJOR NON AUTOMOTIVE CUSTOMERS



**JOHN DEERE**



**TOPBAND 拓邦**



# SALES DISTRIBUTION (Sales in Lakhs)

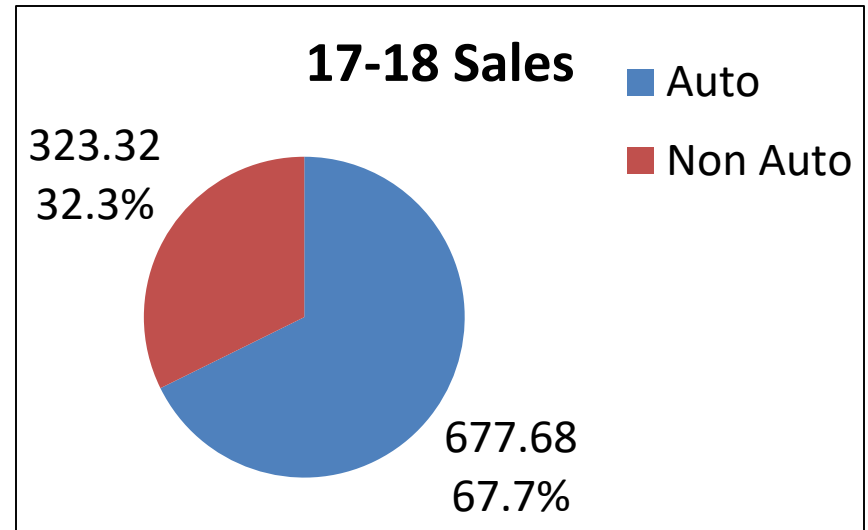
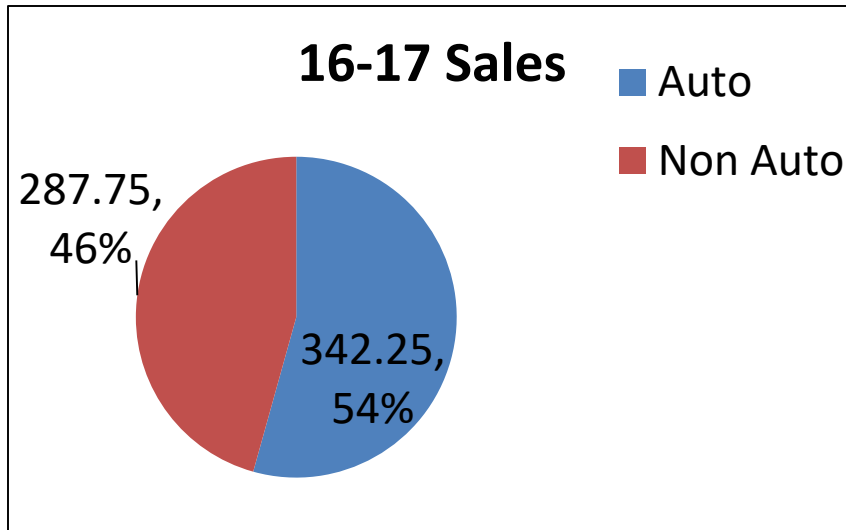
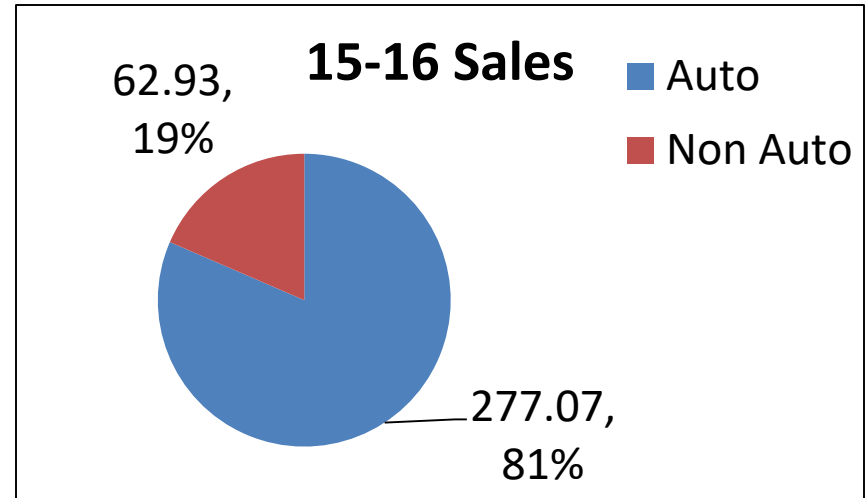
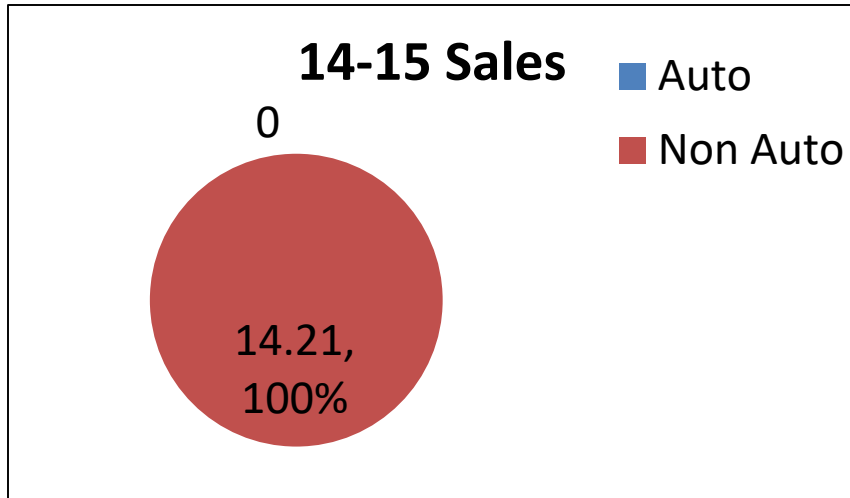

# SALES DISTRIBUTION (Sales in Lakhs)

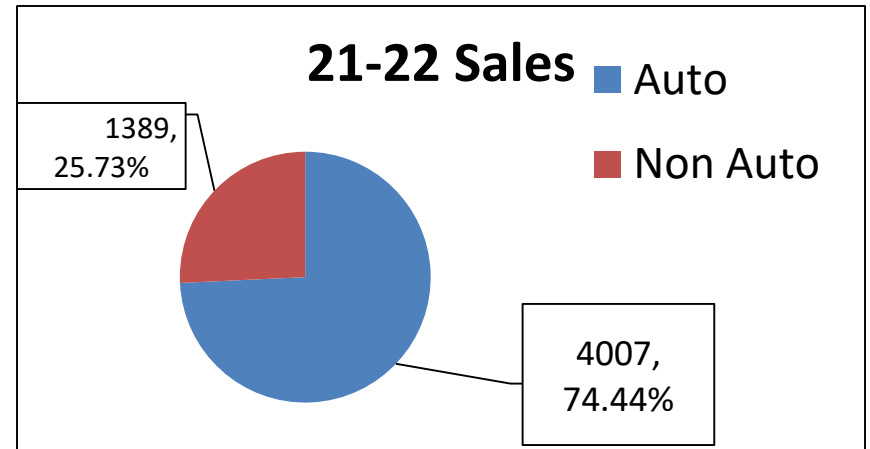
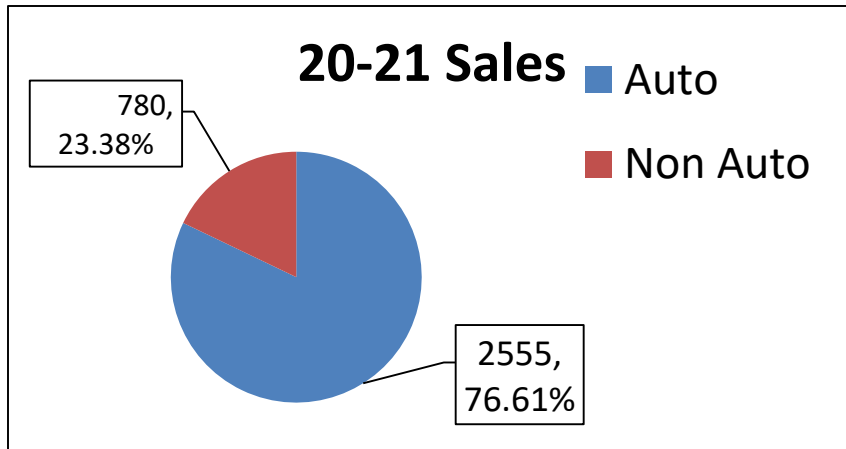
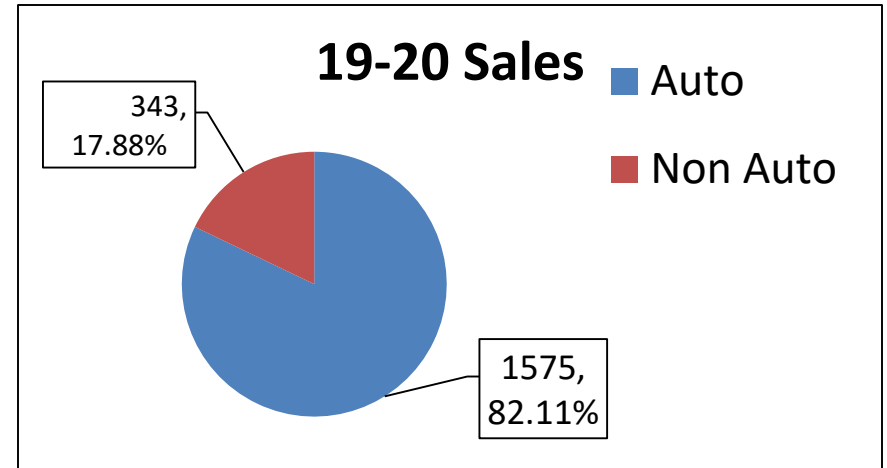
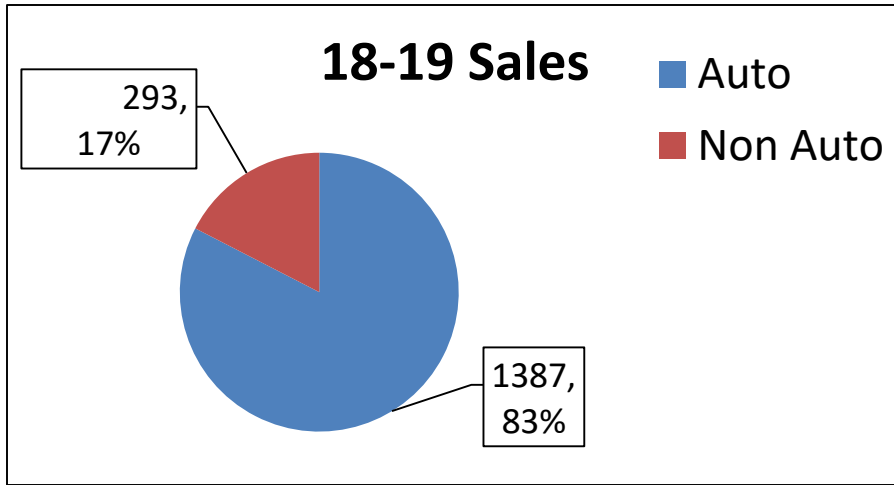

# SALES DISTRIBUTION (Sales in Lakhs)

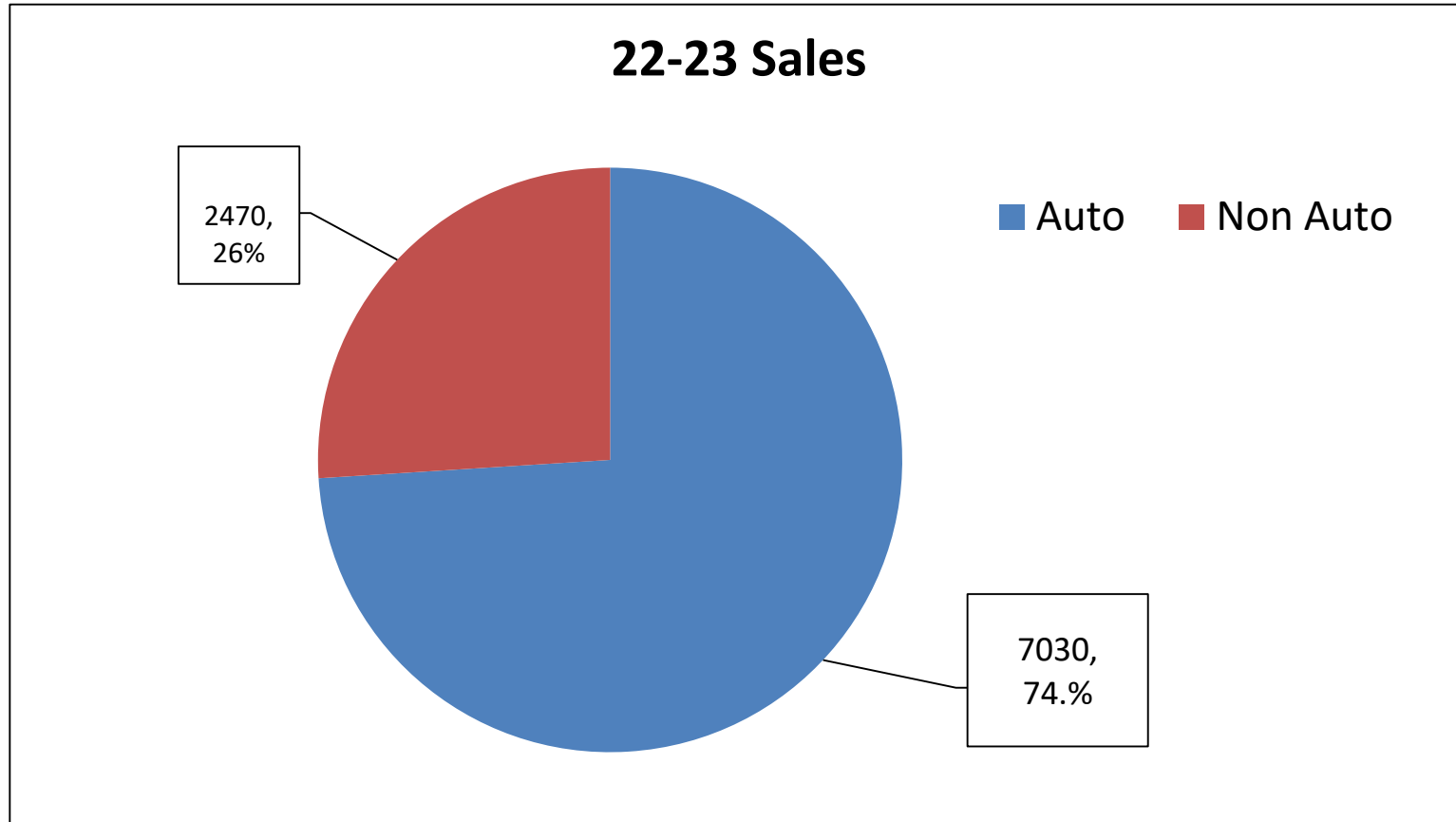

# ENHANCEMENT PLANS



- 1. SETTING UP TESTING LABORATORY**
- 2. CERTIFICATION OF ISO 14001:2015 EMS**
- 3. WITH IN ONE YEAR WE WILL PROVIDE ROBO SPECIALITY ON 100% MACHINES**

**THANK YOU**